

Centralite Wall Panels: Precast Concrete "Frame Wall" Construction

Centralite Wall Panels offer the convenience of cavity wall construction with the speed and durability of precast concrete. It is priced competitively with other foam and concrete wall systems and is lightweight, which results in more economical delivery and rapid installation.

Centralite can be placed with the concrete surface on the exterior or interior. Either exterior siding or interior finishes are installed on the foam side of the panel. Gypsum board and other finish materials are attached quickly and easily to the galvanized steel channels that are cast into the concrete studs.

Centralite is delivered to the job site ready for electrical installation. Switch and outlet boxes as well as wiring are installed within the wall similar to other frame wall systems. Hollow metal



doorframes can be cast into Centralite panels at the plant. Rough openings can also be provided for job site installation of doors and windows. Centralite is manufactured using 5000 psi concrete and can be used as a load-bearing wall to support various floor and roof systems.

Insulation values and fire resistance ratings vary depending on concrete thickness and finish materials. Centralite is typically cast using expanded polystyrene, however, other types of insulation are available.

TYPICAL CROSS SECTION

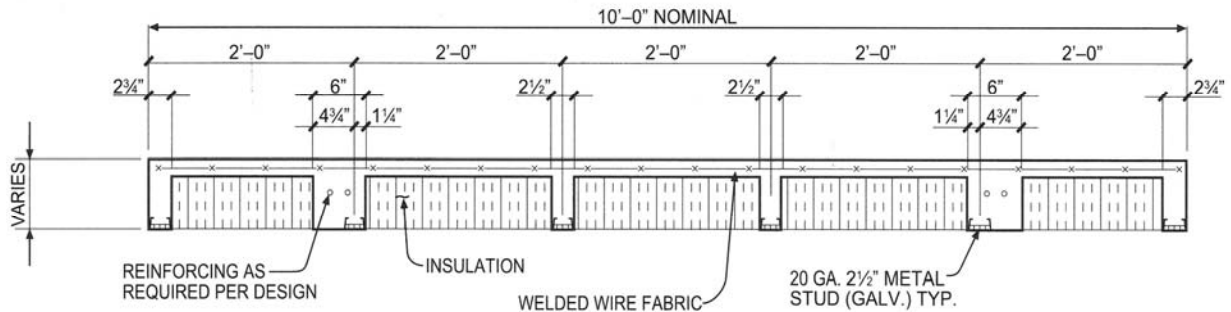

Note: Overall panel thickness varies per design loads, wall height and desired insulation value.

